

NOTE  
Z= VARIABLE ACCORDING TO WIND  
ZONES, REFER TO NZBC E2 AS1 TABLE 7  
(70mm TYPICAL)

NOTE: TYPICAL EXISTING CAP FLASHING WILL  
BE REMOVED (IF PRESENT)

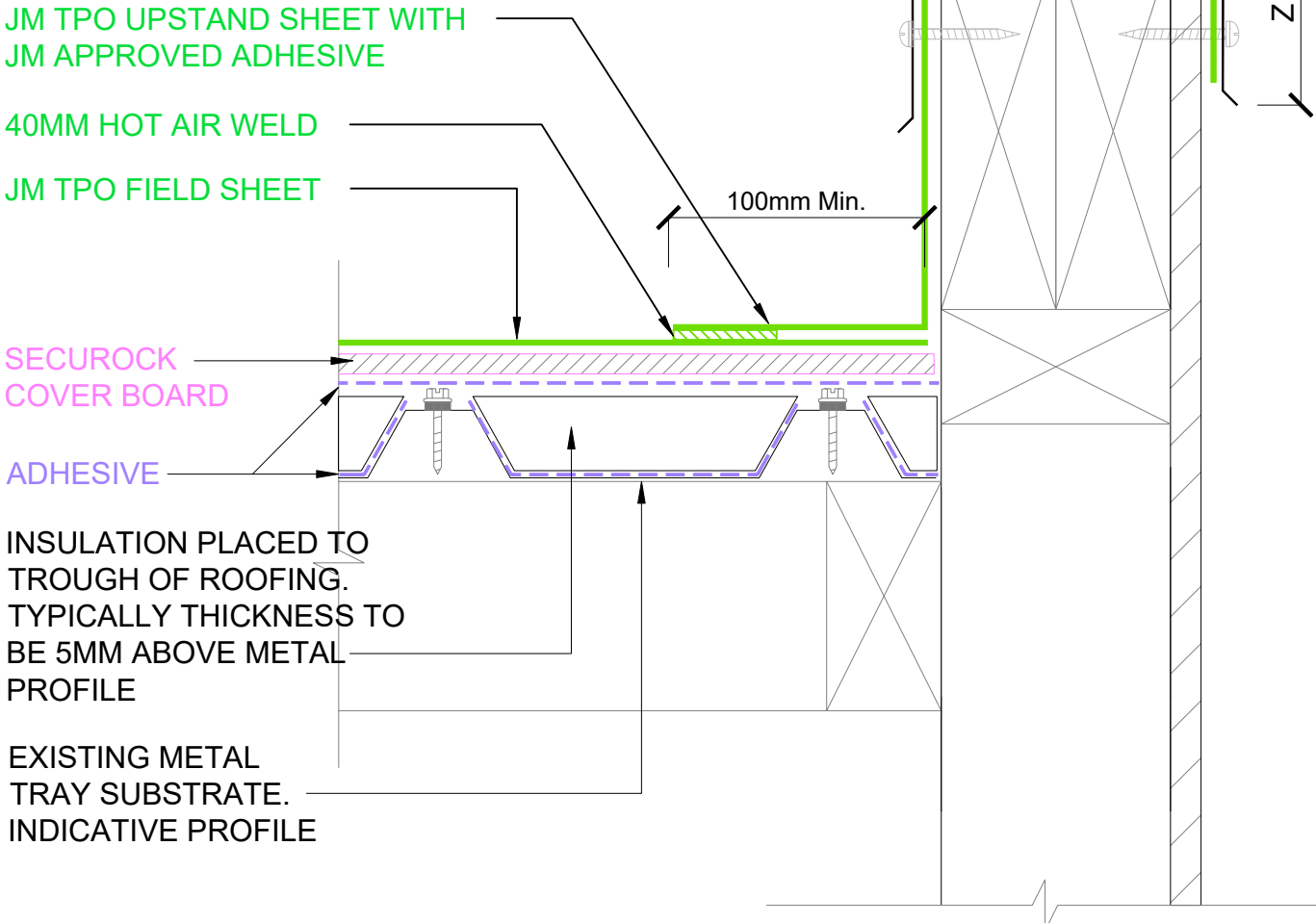
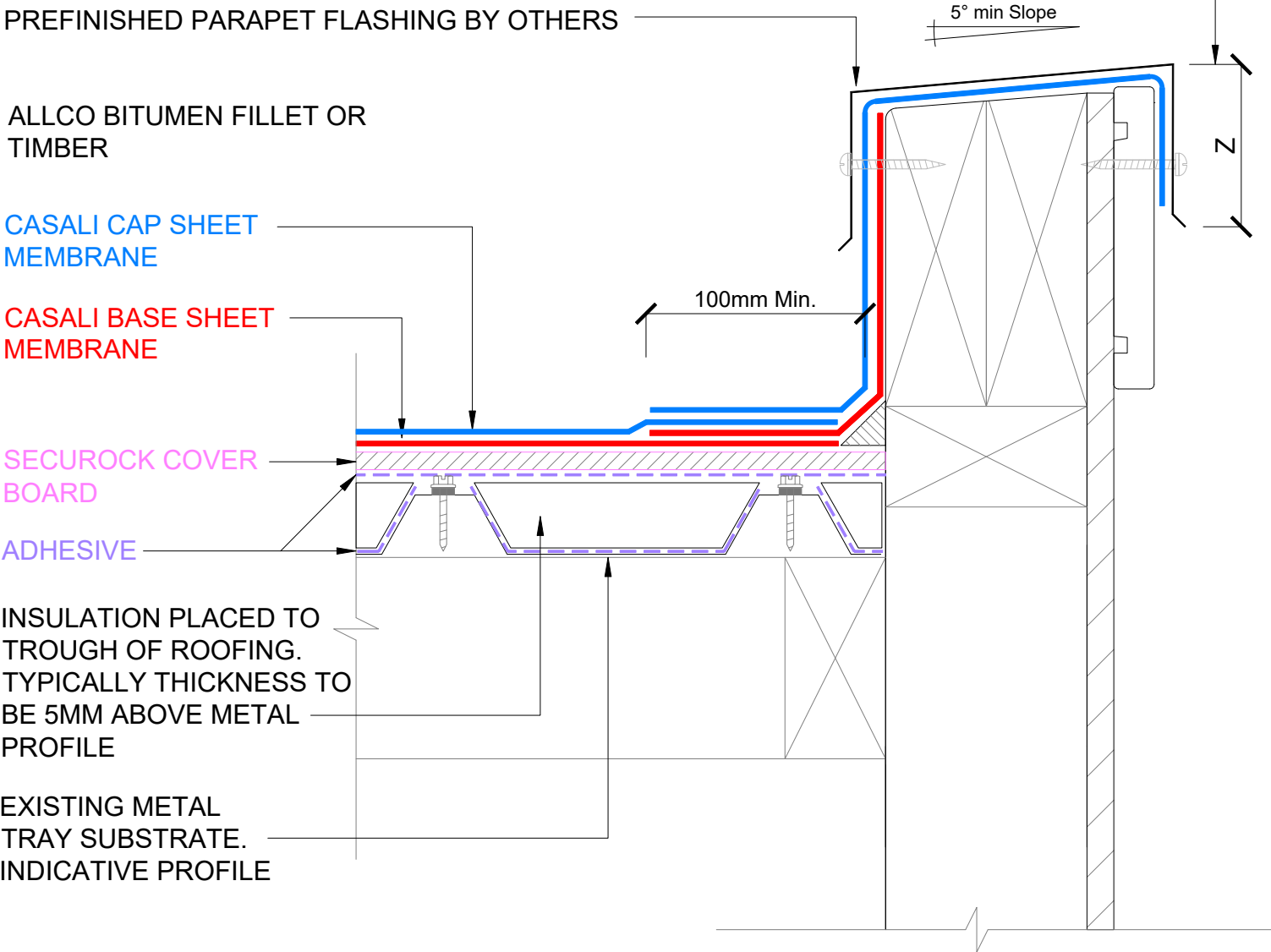

1 RECOVER ROOF - CASALI - TYPICAL PARAPET  
SCALE: NTS

2 RECOVER ROOF - JM TPO - TYPICAL PARAPET  
SCALE: NTS

The information and data contained herein are believed to be accurate and reliable.  
This information does not constitute a warranty and should be used in conjunction with  
the project specification document supplied by Allco Waterproofing Solutions Ltd  
Please contact Allco Waterproofing Solutions Ltd with any questions or deviations from  
this information.  
© Allco Waterproofing Solution Ltd

For Technical Advice Contact:  
Web: [www.allco.co.nz](http://www.allco.co.nz)  
Email: [info@allco.co.nz](mailto:info@allco.co.nz)  
Telephone: 09 448 1185  
Facsimile: 09 448 1186



DRAWN BY:  
ALLCO

DATE:  
05/24

DRAWING REF:  
RC-002

REV:  
2