

NOTE

USE HYDROTECH **FLEX-FLASH UN**
- WHERE MINOR MOVEMENT OR
CHANGE IN LEVEL DIRECTION OR
DISSIMILAR MATERIALS OCCUR

OTHERWISE... US **FLEX-FLASH F**
FOR CONCRETE TO CONCRETE
TRANSITIONS

NOTE

HYDROTECH MUST BE LAID
WITH A **PROTECTION SHEET**
OVER THE MM6125.
HYDROFLEX 30 or CASALI
OLYMPIA or CASALI CAP SHEET

HYDROTECH MM6125 MEMBRANE SYSTEM

PROTECTION SHEET

1ST LAYER.

2ND LAYER.

FLEX-FLASH F

CONCRETE
SUBSTRATE

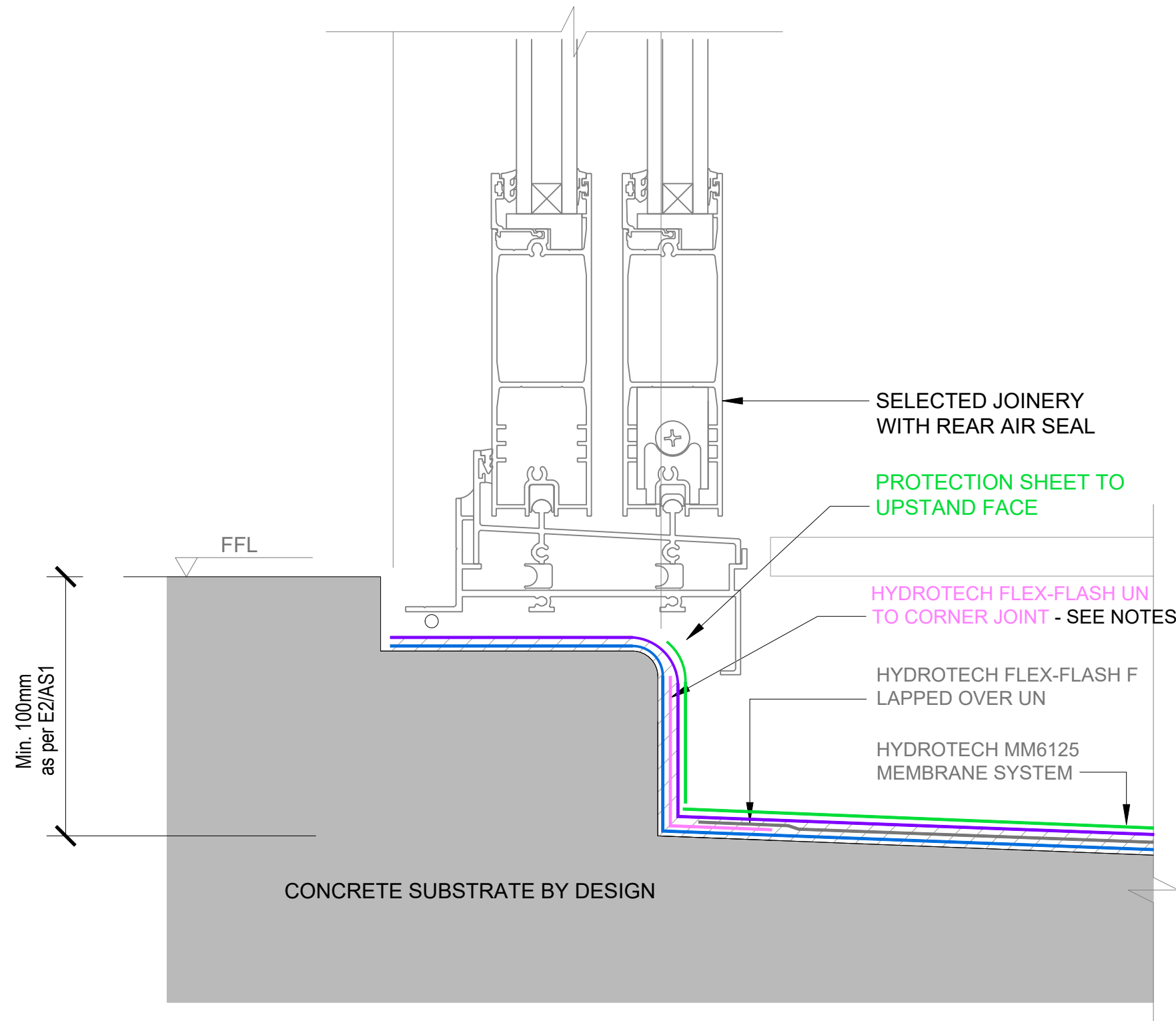

1

HYDROTECH - WINDOW SILL / BALCONY SETDOWN

SCALE: NTS



The information and data contained herein are believed to be accurate and reliable.
This information does not constitute a warranty and should be used in conjunction with
the project specification document supplied by Allco Waterproofing Solutions Ltd
Please contact Allco Waterproofing Solutions Ltd with any questions or deviations from
this information.
© Allco Waterproofing Solution Ltd

For Technical Advice Contact:
Web: www.allco.co.nz
Email: info@allco.co.nz
Telephone: 09 448 1185
Facsimile: 09 448 1186



DRAWN BY:
ALLCO

DATE:
06/19

DRAWING REF:
H-001

VER:
1.1