

NOTE - WALL MEMBRANE OPTIONS:

CASALI OLYMPIA MEMBRANE CAN BE
SUBSTITUTED FOR CASALI ADERIX
MEMBRANE.

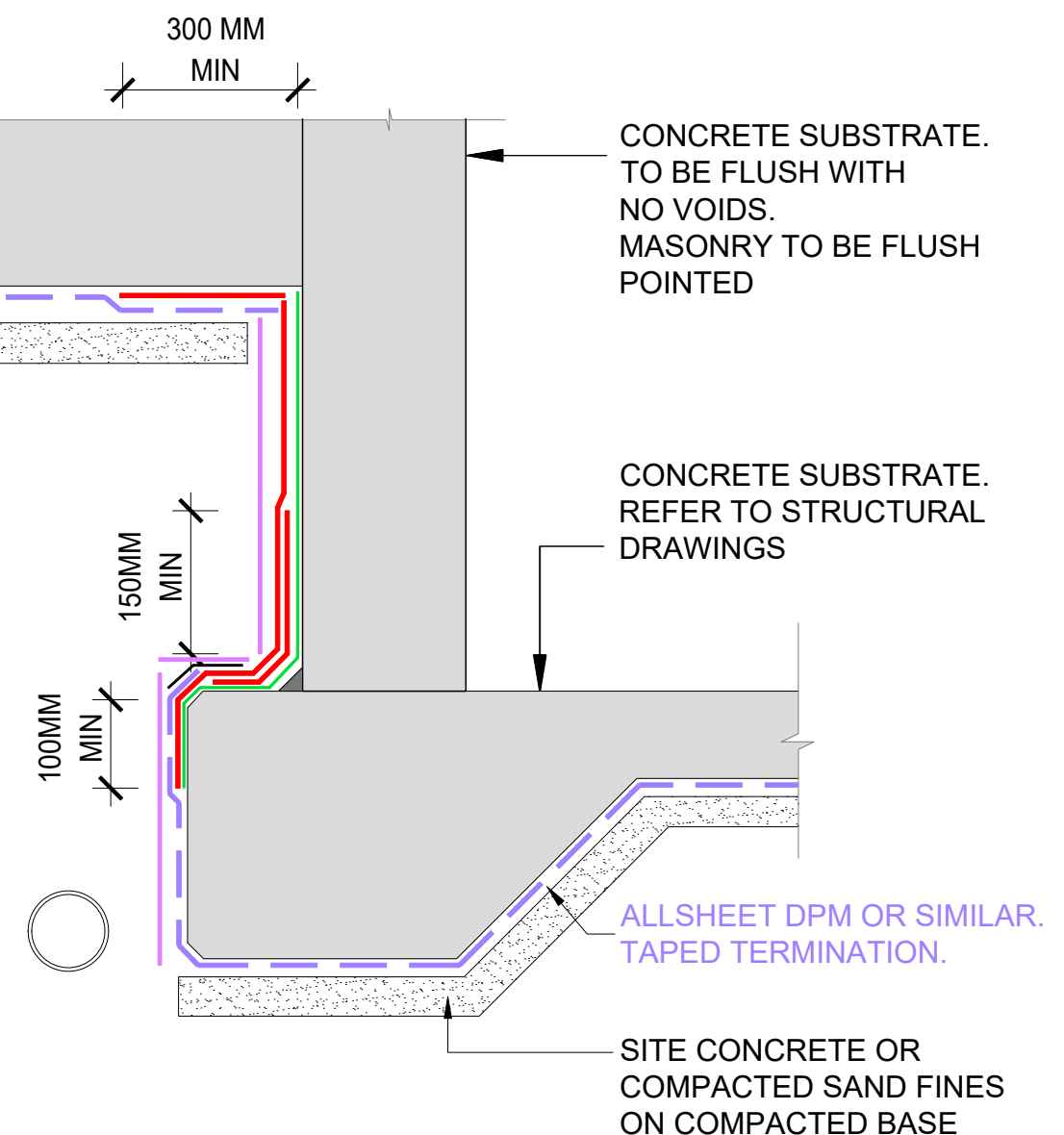

1

RETAINING WALL / HEELED FOOTING JUNCTION - MULTILEVEL

SCALE: NTS

2

RETAINING WALL / HEELED FOOTING JUNCTION - MULTILEVEL

SCALE: NTS

DPM TO FOOTING AND SLAB



The information and data contained herein are believed to be accurate and reliable.
This information does not constitute a warranty and should be used in conjunction with
the project specification document supplied by Allco Waterproofing Solutions Ltd
Please contact Allco Waterproofing Solutions Ltd with any questions or deviations from
this information.
© Allco Waterproofing Solution Ltd

For Technical Advice Contact:
Web: www.allco.co.nz
Email: info@allco.co.nz
Telephone: 09 448 1185
Facsimile: 09 448 1186



DRAWN BY:
ALLCO

DATE:
07/2023

DRAWING REF:
CA-PS-05

REV:
1