

NOTE
VOLTEX IS GENERALLY RECOMMENDED TO BE BONDED / PRE-APPLIED TO THE PRECAST PANEL IN THE FORMING YARD. IT CAN BE SITE APPLIED BUT SHOULD BE BACK FILLED PROMPTLY - WEATHER DEPENDANT. VOLTEX, WHEN PRE-APPLIED, CAN BE EXPOSED FOR LONGER PERIODS

1

PRECAST WALL PANEL FULL STITCH JOINT - VOLTEX

SCALE: NTS

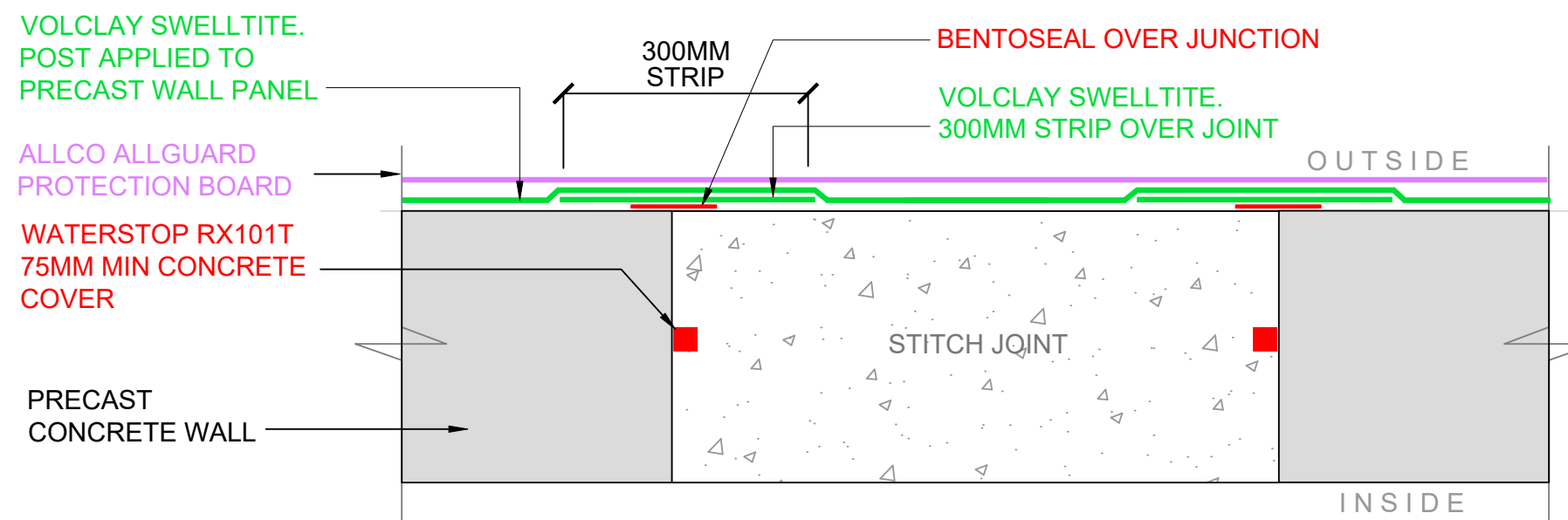

2

PRECAST WALL PANEL FULL STITCH JOINT - SWELLTITE

SCALE: NTS



The information and data contained herein are believed to be accurate and reliable. This information does not constitute a warranty and should be used in conjunction with the project specification document supplied by Allco Waterproofing Solutions Ltd. Please contact Allco Waterproofing Solutions Ltd with any questions or deviations from this information.
© Allco Waterproofing Solution Ltd

For Technical Advice Contact:
Web: www.allco.co.nz
Email: info@allco.co.nz
Telephone: 09 448 1185
Facsimile: 09 448 1186



DRAWN BY:
ALLCO

DATE:
06/23

DRAWING REF:
V-W-02A

REV:
2