

STRATA SEAL™ HR

Hot Applied Rubberized Asphalt Waterproofing Systems

*Protected Membrane Roof • Plaza Deck • Split Slab Construction
Parking Deck/Tunnel/Bridge • Landscaped • Greenroof*

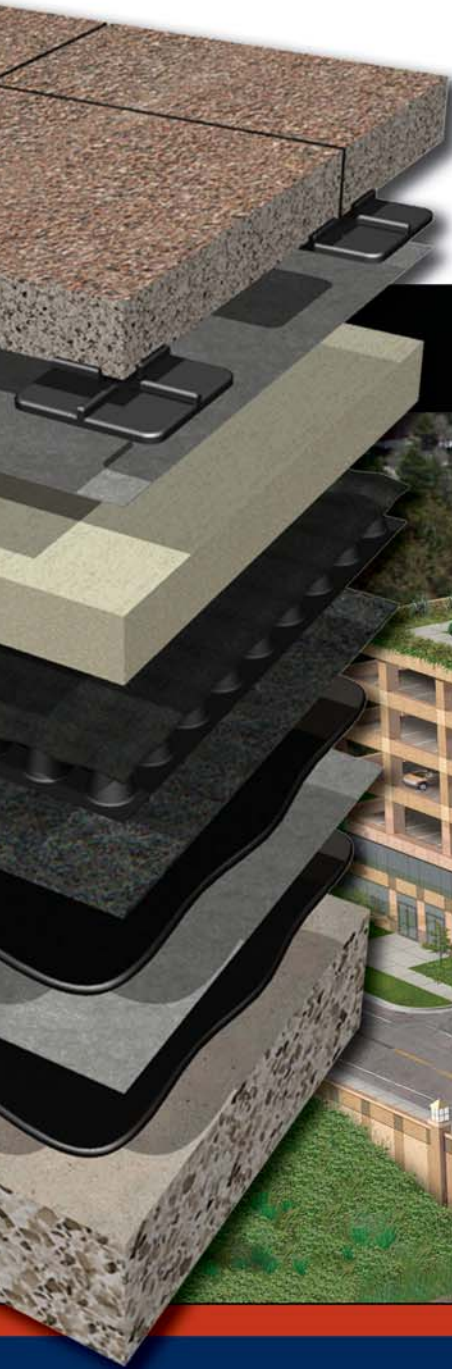

CETCO
BUILDING MATERIALS GROUP

Strataseal HR

From a global leader in mineral technology, Strataseal HR represents the next step in hot-applied rubberized membrane solutions for roofing and horizontal waterproofing applications. It combines decades of membrane polymer experience and advanced mineral enhancement technology into a 100% solids thermoplastic product that is flexible as well as self-sealing.

Strataseal HR is a tough, seamless membrane that eliminates the inconvenience and inaccuracy of mixing or curing associated with two-component products. When you're in a hurry to seal your structure, don't be caught *waiting for a "cure"* – Strataseal HR is ready for use and requires no set-up to provide a water-tight membrane.

It features the dependability of hot-applied technology, while meeting and exceeding the requirements of the Canadian General Standards Board (CGSB 37.50-M89) as well as ASTM International: they provide performance and testing standards for Hot-Applied Rubberized Asphalt Roofing and Waterproofing Systems.

Strataseal HR

Strataseal HR is the seamless solution for your horizontal waterproofing needs. With advanced adhesion properties, it confines water migration to the damaged area; adheres to and fills most surface irregularities; can be installed in temperatures as low as 0°F and once applied, is also backed by the industry-leading quality assurance program – HydroShield!

While all Strataseal HR assemblies require at least 180 mils un-reinforced or 215 mils reinforced, the ancillary components will vary by application. The basic assembly includes Strataseal HR applied to a thickness of 180 mils. A higher performance HydroShield-eligible assembly is obtained through the use of 215 mils of Strataseal HR with reinforcement. This consists of a 90 mil layer with a reinforcement fabric embedded onto the exposed surface followed by a second layer of Strataseal HR applied to a total thickness of 215 mils. Both assemblies can be used on cast-in-place concrete decks, composite decks, and pre-cast concrete decks, while the reinforced system may also be used over wood plank, plywood, or metal decks with gypsum board.

Applications

With the flexibility of its performance, the applications of Strataseal HR are varied. It can be installed as a component of a protected membrane roof, a plaza deck, an asphalt paving assembly, split-slab construction, tunnels as well as planters, greenroofs or other landscaped assemblies. It's suitable for use in new construction as well as retrofit applications.

CETCO offers a complete system of waterproofing products which include thermal and moisture protection, drainage products, decorative pavers and pre-cast components, greenroof components, active waterstops, as well as remedial waterproofing materials.



Assembly Options

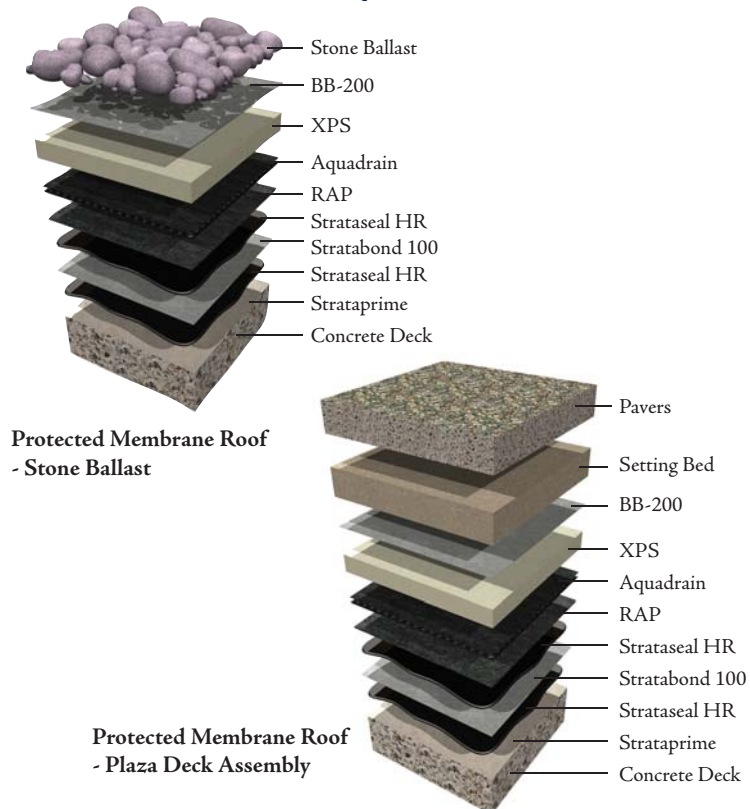

Protected Membrane Roof Assembly

Considered to be the most secure of the roof assemblies, the Protected Membrane Roof System includes insulation as well as ballast installed over the membrane, protecting it from various sources of potential damage or long term degradation. The ballast material consists of stone or architectural pavers.

Split-Slab Construction Assembly

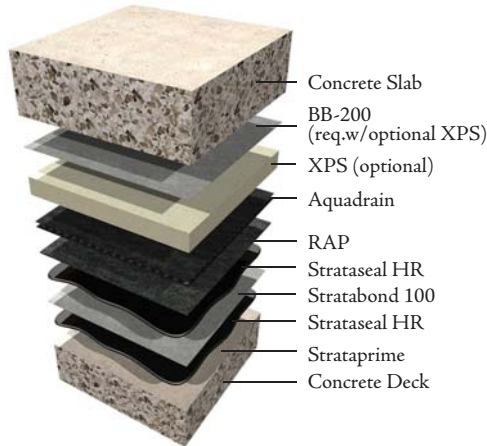

Asphalt Paving Assembly

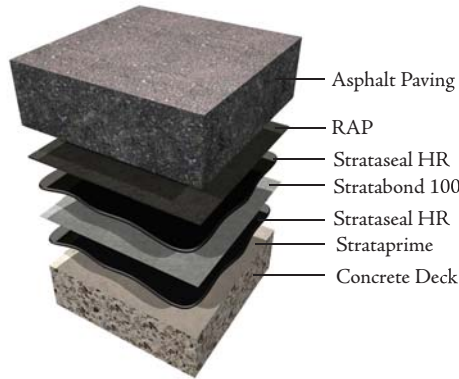

Plaza Deck Assembly

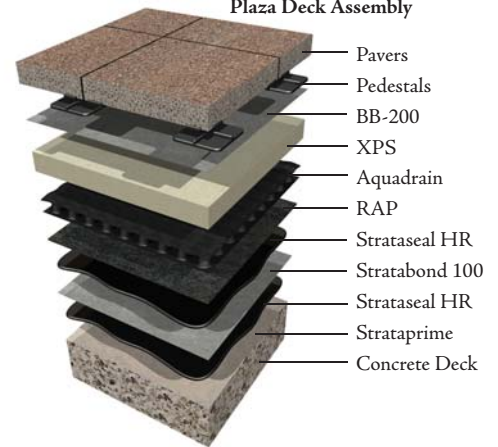

Split-Slab Construction Assembly

This type of construction is characterized by the membrane being encased within the concrete slab. Typically, insulation and drainage are placed under the concrete slab.

Asphalt Paving Assembly

This application is characterized by asphalt pavement being applied on top of the membrane for use as a parking deck, bridge, or tunnel. Typically, the asphalt is placed on the protection sheet without insulation and a drainage component.

Plaza Deck Assembly

These assemblies include the use of pavers placed on pedestals or spacing tabs – typically, these are placed directly on the XPS insulation layer. A filter fabric is installed over the XPS insulation keeping the insulation in place even during torrential downpours.

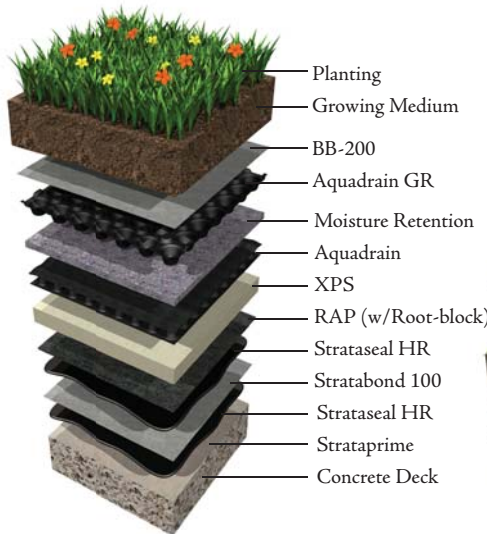

Greenroof Assembly - Extensive



Greenroof Assembly - Intensive

Landscaped Assembly

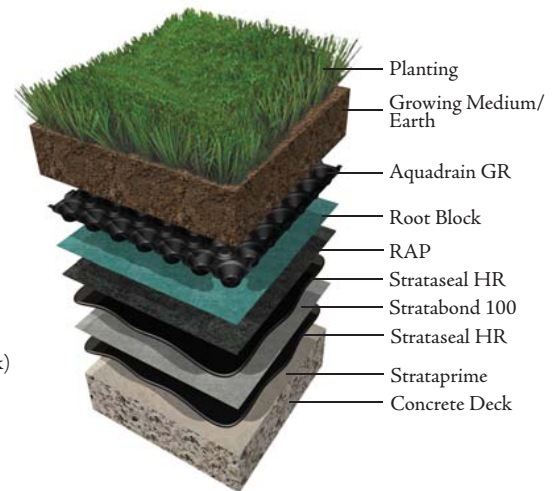

Greenroof Assembly

Greenroofs provide numerous benefits to a structure including additional insulation, improved storm water management, expanded usable building space through functional hardscape components, as well as environmental contributions through re-oxygenation of the air, processing of airborne contaminants, and absorption of noise. They substantially increase the direct and intrinsic value of the structure while providing a healthier environment to its inhabitants.

Landscaped Assembly

This is the most basic of the planting assemblies where grass or small, light plantings are placed in soil or a growing medium. A Landscaped Assembly is considered different from a Greenroof in that it is typically not designed to provide the benefits of the greenroof system and is conventionally used in applications such as planters.

In order to meet the challenges of today's construction techniques, CETCO continues to evolve. With our first waterproofing patent in 1942, we've looked for innovative ways to bring value and security to our customers. Decades later, we remain committed to advancing the science with new solutions and the core belief that quality must come first.

CETCO supports its products and services with HydroShield - the industry's most extensive Quality Assurance Program. It is indicative of the confidence we have in our products as well as the services and skills of our industry partners. It features design / architectural support, site-specific AutoCAD details, material installation by experienced approved applicators, third party independent inspection as well as the financial security of the industry's only no-dollar-limit warranty – all from a single source.

Using a qualified single source for your commercial waterproofing requirements means more - more control, more quality, more service, and the knowledge that your investment is secure with one phone call. Achieve more with building envelope solutions from CETCO.

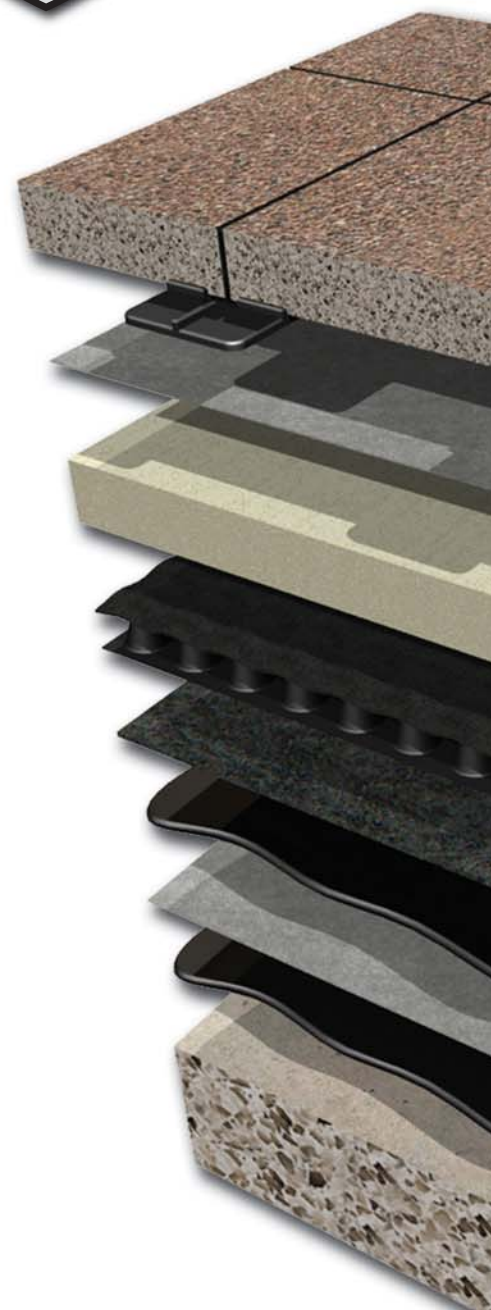

Wall / Deck Envelope

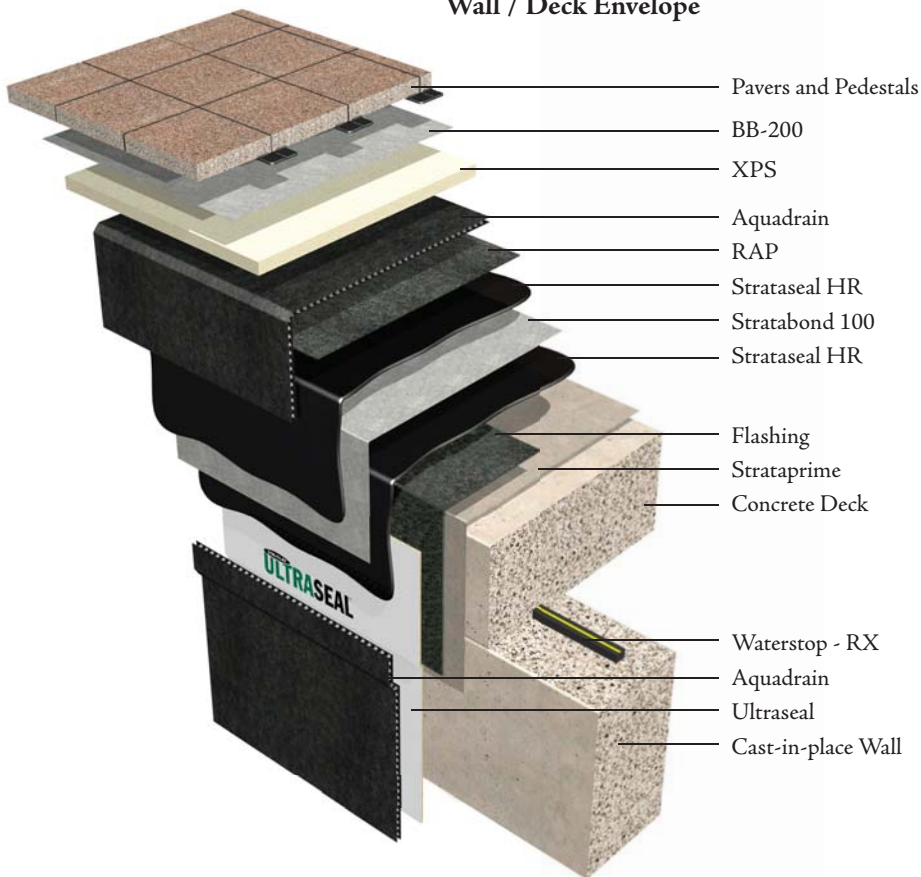

July 2006 (Supersedes All Previous Versions)

The information contained herein supersedes all previous versions printed prior to July, 2006, and is believed to be accurate and reliable. CETCO makes no warranty of any kind and accepts no responsibility for the results obtained through application of this information. CETCO reserves the right to update information without notice.

www.cetco.com

PH 800.527.9948 or 847.392.5800 • FAX 847.506.6195
1500 West Shure Drive • Arlington Heights, IL 60004

© 2006 CETCO Printed in the U.S.A. July 2006 - SS001