



At the Lab. In the Field.
By Your Side.

KRYSTOL T1™ & T2™ CEMENTITIOUS CONCRETE WATERPROOFING

Product Code: K-210 & K-220

September 2006

QUESTIONS: 1-800-267-8280 or www.kryton.com

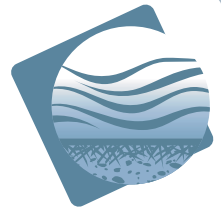

CONCRETE
WATERPROOFING

DESCRIPTION

KRYSTOL T1 & T2 Waterproofing System™ is a cementitious, brush-applied, treatment for concrete. KRYSTOL T1 & T2 contain the proven world-renowned Krystol waterproofing chemicals. KRYSTOL T1 is applied to the concrete first followed by KRYSTOL T2. When applied in accordance with manufacturer's specifications, the Krystol system is warranted for use in place of conventional waterproofing systems. KRYSTOL T1 & T2 react chemically within the concrete mass to form billions of needle-like crystals which block the pores, voids and microcracks in concrete. Presaturation and subsequent re-wetting of the surface will cause deeper diffusion of the organic chemicals and formation of crystals at greater depth.

FEATURES

- Stops water movement through concrete
- Provides a permanent treatment
- Protects reinforcing steel against corrosion
- Waterproofs minor cracking
- Waterproofing increases with time
- Reaches well below the surface and is not affected by surface wear or abrasion
- Treated concrete withstands significant hydrostatic pressure
- Treatment may be applied to positive or negative (inside) surface of concrete
- Treatment may be applied to old or new concrete
- Non-toxic and approved for use in drinking water containment

RECOMMENDED USES

- Concrete foundations and walls
- Concrete slabs on grade
- Elevated slabs and ramps
- Elevator pits and equipment pits
- Parking structures
- Swimming pools and water features
- Water towers, reservoirs and storage tanks
- Tunnels, pipes and underground vaults
- Water treatment reservoirs
- Bridge decks
- Marine structures

PHYSICAL PROPERTIES OF KRYSTOL T1™

Color	Gray
Texture	Powder
Particle Size	40-150 microns
Bulk density	1.4
PH (when mixed)	13
Rate of Penetration	2 mm per week
Water pressure resistance	150 ft head, min.
Chloride penetration	Measured 15 mm below surface after 90 days ponding with 10% CaCl ₂ H ₂ O
Control	0.167%
Krytol Treated	0.009%

PHYSICAL PROPERTIES OF KRYSTOL T2™

Color	Gray
Texture	Powder
Particle Size	40-150 microns
Bulk Density	1.35
PH (when mixed)	12
Shelf Life	2 years

TECHNICAL DATA

PERFORMANCE

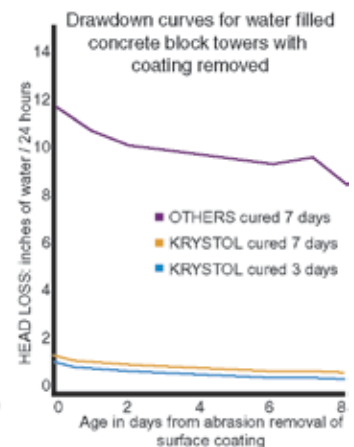
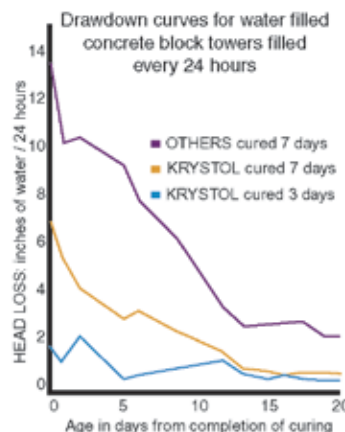

Independent testing concludes that KRYSTOL™ T1 & T2 Waterproofing System is a permanent, in-depth waterproofing treatment.

The Kryton Group of Companies.

1645 East Kent Avenue, Vancouver, BC Canada V5P 2S8 Tel: 1-604-324-8280 Toll Free: 1-800-267-8280 Fax: 1-604-324-8899 E-mail: info@kryton.com Web: www.kryton.com

KRYSTOL™ T1 & T2

CEMENTITIOUS CONCRETE WATERPROOFING

Product Code: K-210 & K-220

Page 2 of 2

APPLICATION

KRYSTOL T1 & T2 Waterproofing System is a two slurry coat application. Under special circumstances a single coat of KRYSTOL T1 may be approved by the manufacturer.

Prior to application all cracks and joints must be repaired according to Specification No. 1. Concrete must be free from paints, sealers, oil, grease, bitumen, laitance and other contaminants (see Technical Bulletin #202). Surfaces to be treated must be pre-soaked with clean water to a saturated surface dry (SSD) condition. Do not leave any standing water.

Mix KRYSTOL T1 to a slurry consistency (5 parts powder to 2 parts clean water). With a concrete brush, use an aggressive circular motion to coat the concrete with the KRYSTOL T1 slurry mix. Allow KRYSTOL T1 to harden (generally 3 hours).

Mix KRYSTOL T2 to a slurry consistency (5 parts powder to 2 parts clean water). With a concrete brush, use an aggressive circular motion to overcoat the KRYSTOL T1 application with KRYSTOL T2.

COVERAGE OF SLURRY APPLICATIONS

- 0.8 kg/m² (1.5 lbs/yd²) coat of KRYSTOL T1
- 0.8 kg/m² (1.5 lbs/yd²) coat of KRYSTOL T2

CURING

Completed applications should be moist cured for 48 hours and protected from rain and light traffic for 12 hours. Heavy traffic should be avoided until the surface has hardened. Treated concrete surfaces should not be permanently exposed to liquids for 7 days. Finishes containing Portland cement may be applied over KRYSTOL T1 & T2 after 3 hours but other paint and coating finishes should not be applied before 28 days.

PACKAGING

- KRYSTOL T1 & T2 are packaged in the following standard sizes:
- 5 kg pails
 - 25 kg pails

WATERPROOF ALL CONSTRUCTION JOINTS

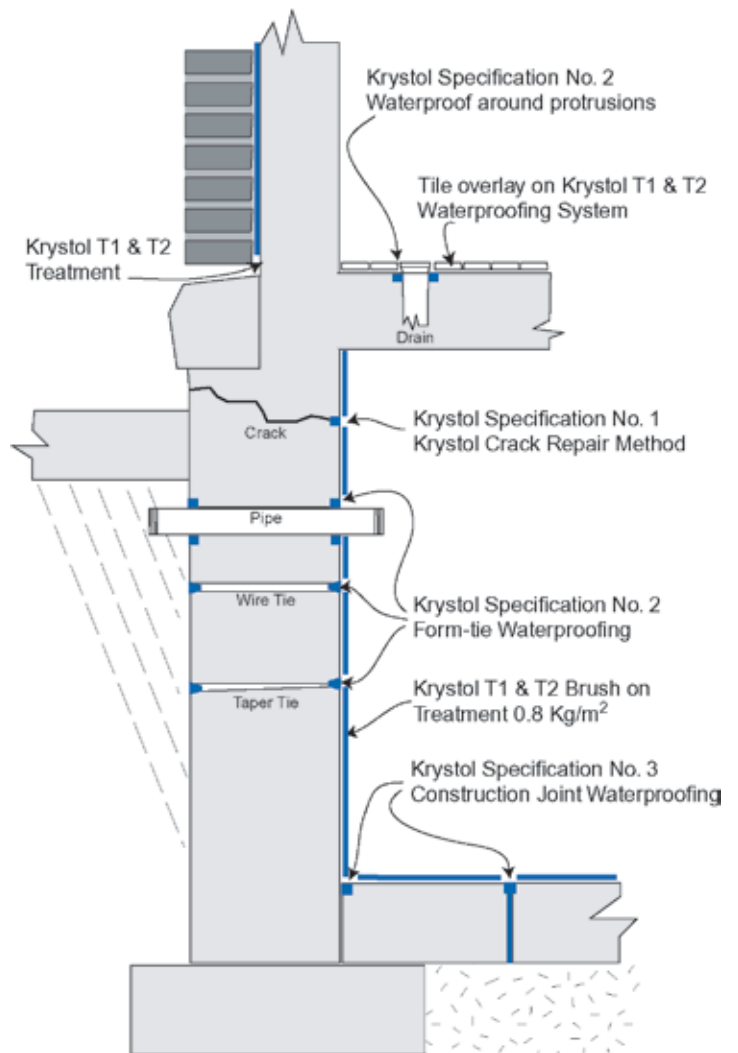

SPECIFICATIONS

- For repairing cracks, joints and holes in concrete refer to TECHNICAL BULLETIN #101
- For waterproofing an existing concrete drywell or wetwell refer to TECHNICAL BULLETIN #102
- For waterproofing new concrete construction joints refer to TECHNICAL BULLETIN #104

PRECAUTIONS

- Application should not be made when the surface temperature is below 5°C (41°F).
- KRYSTOL T1 & T2 is not a decorative coating and will change the color of the surface that it is applied to.
- KRYSTOL T1 & T2 has a high pH, when mixed with water. Use suitable protective clothing and eye protection.
- Please refer to the MSDS for more detailed information.

The Kryton Group of Companies.

1645 East Kent Avenue, Vancouver, BC Canada V5P 2S8 Tel.: 1-604-324-8280 Toll Free: 1-800-267-8280 Fax: 1-604-324-8899 E-mail: info@kryton.com Web: www.kryton.com