

PLAZA DECK

Deck to Wall Outside Corner Detail

HR-409

No Scale - 07/07

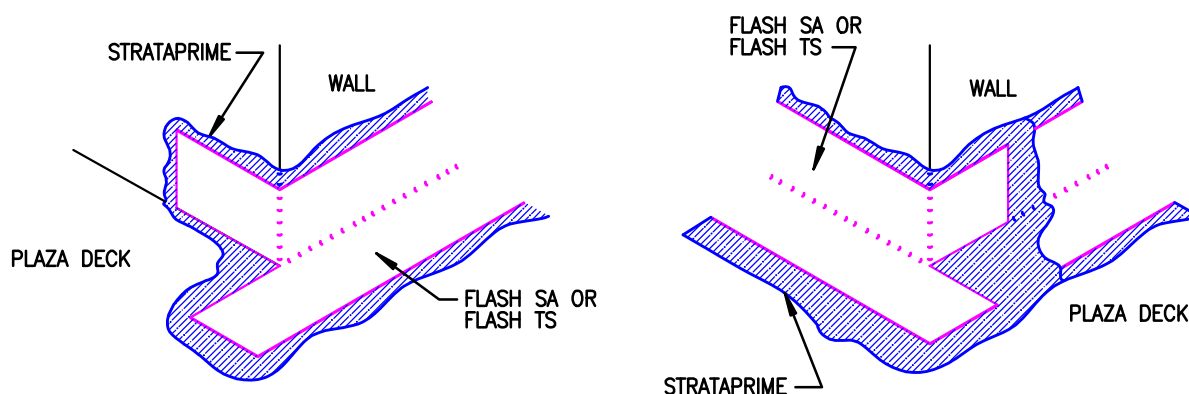

STEP 1 APPLY PRIMER AND INSTALL FIRST LAYER OF FLASHING AS SHOWN

STEP 2 APPLY ANOTHER LAYER OF PRIMER AND INSTALL SECOND LAYER OF FLASHING AS SHOWN

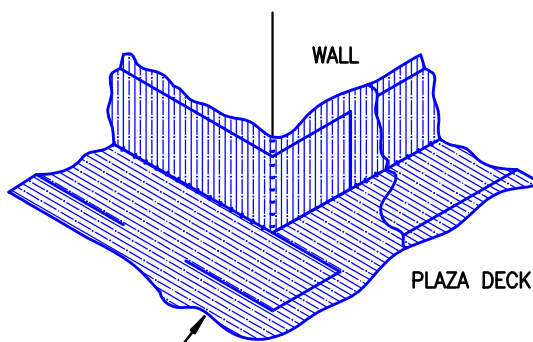

STEP 3 COMPLETELY COAT FLASHING WITH STRATASEAL HR IMMEDIATELY AFTER INSTALLATION



For Technical Advice Contact:
**Peter Stevens or
Alex Valentine**
(0275) 420 225 (PS)
(0275) 420 228 (AV)

The information and data contained herein are believed to be accurate and reliable. This information does not constitute a warranty and should be used in conjunction with the project specification document and Quality Assurance manual supplied by Allco Agencies Ltd. Please contact Allco Agencies Ltd with any questions or deviations from this information. © Allco Agencies Ltd 2006