

Stitch Joint Corner Detail**D-111A**

No Scale—10/06

Backfill 20/7 or River Run Metal

Compacted backfill to a minimum of 85% Modified Proctor Density.
Backfill material and procedure to be discussed with an Allco Agencies Ltd Representative.

1. Place panel.
2. Dry pack joint as required.
3. Bentoseal®.
4. Pin 100mm wide strip Voltex® every 150mm.

NOTE: No access required behind panel

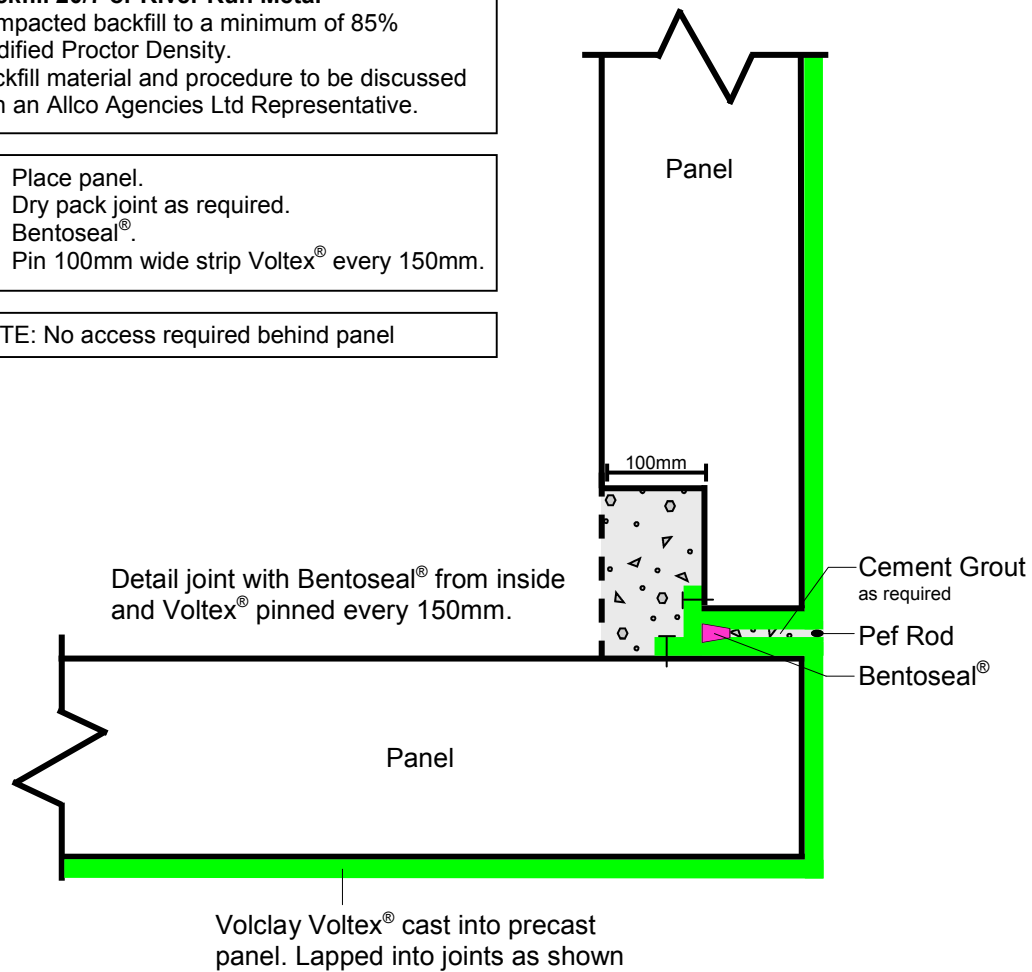

The information and data contained herein are believed to be accurate and reliable. This information does not constitute a warranty and should be used in conjunction with the project specification document and Quality Assurance manual supplied by Allco Agencies Ltd. Please contact Allco Agencies Ltd with any questions or deviations from this information.

© Allco Agencies Ltd 2006



For Technical Advice Contact:

**Peter Stevens or
Alex Valentine**

(0275) 420 225 (PS)

(0275) 420 228 (AV)