

PLAN VIEW

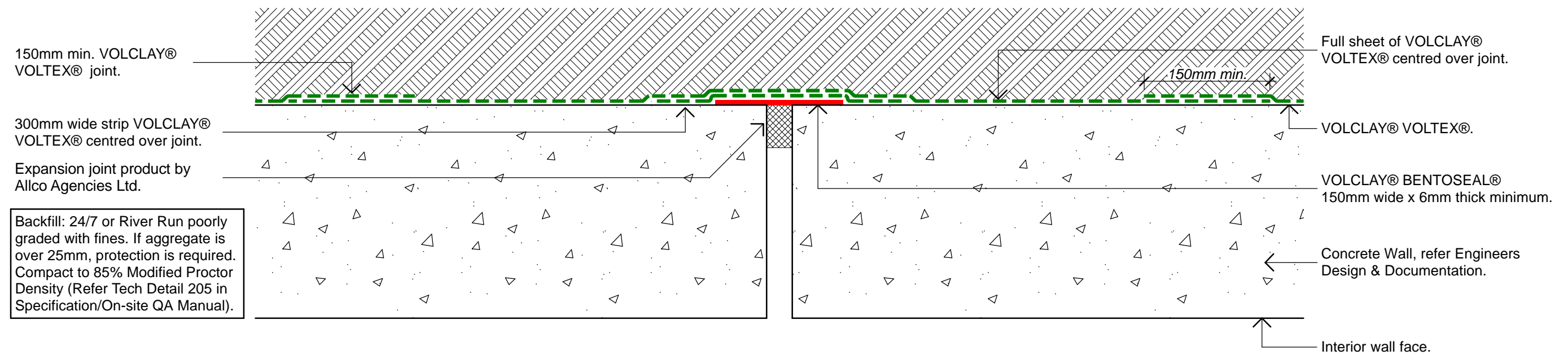

Expansion Joint

Scale 1:5 (A3)

NOTE: VOLTEX® is not designed to waterproof expansion joints, joints require proper expansion joint product manufactured by Emseal. VOLTEX® can be installed over expansion joint products as illustrated above. Check with Allco for the correct Emseal product for your application.

Install VOLTEX® with dark grey (woven) geotextile against concrete

VOLCLAY® WATERPROOFING SYSTEM

FOUNDATION WALL
Expansion Joint



The information and data contained herein are believed to be accurate and reliable. This information does not constitute a warranty and should be used in conjunction with the project specification document and Quality Assurance manual supplied by Allco Agencies Ltd. Please contact Allco Agencies Ltd with any questions and deviations from this information. All drawings are subject to copyright. Unauthorised use is prohibited. © Allco Agencies 2007



For Technical Advice Contact:
Peter Stevens (0275) 420 225 (PS)
Alex Valentine (0275) 420 228 (AV)

DETAIL

VT-214

SCALE: 1:5 (A3)
REVISION: A (May 2008)