

Precast Panel

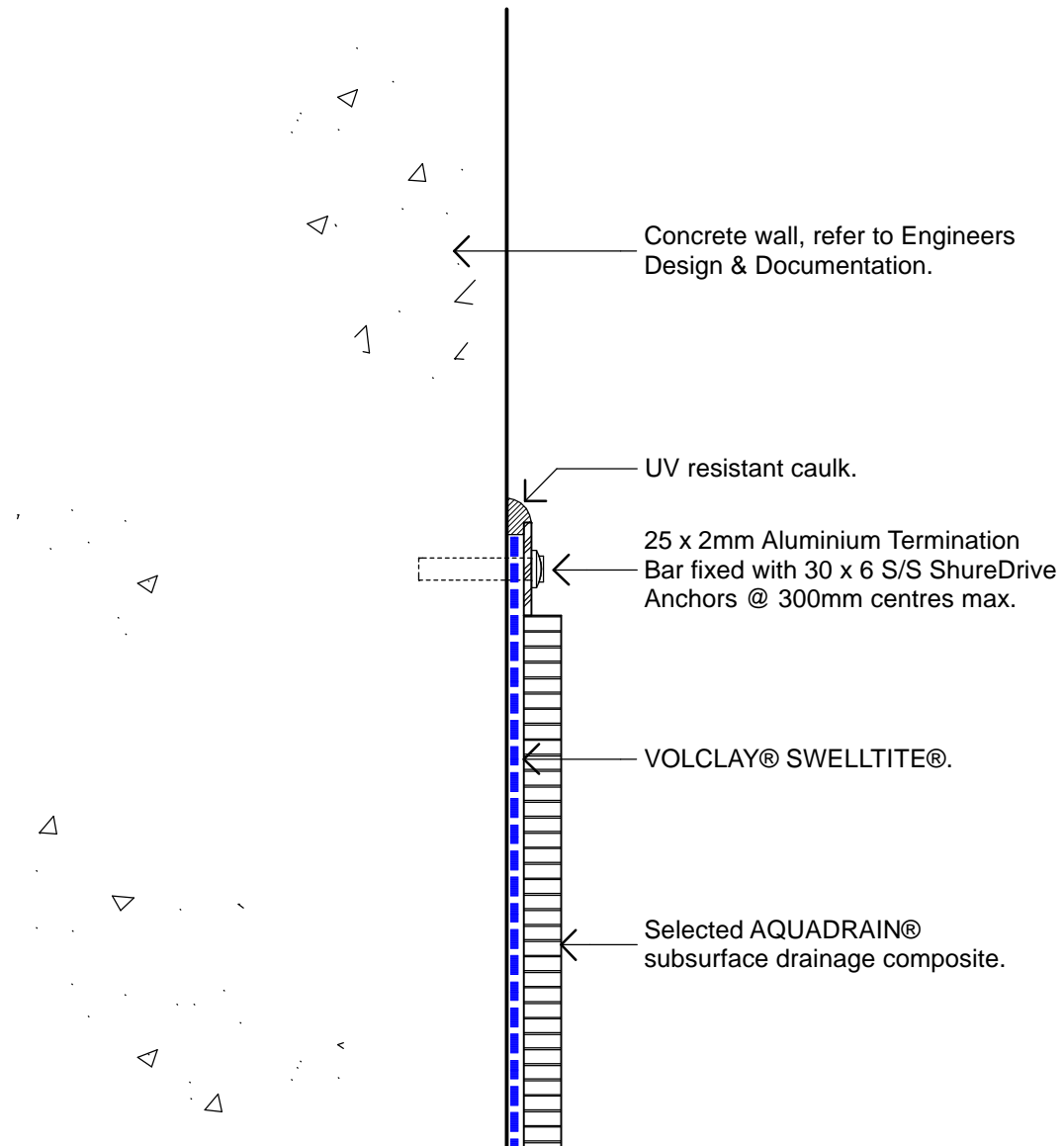

Rigid Termination Bar

Scale 1:2 (A3)

**VOLCLAY® WATERPROOFING SYSTEM**

WALL TERMINATION  
Rigid Termination Bar

**DETAIL**

**ST-208**

SCALE: 1:2 (A3)

REVISION: A (September 2007)



The information and data contained herein are believed to be accurate and reliable. This information does not constitute a warranty and should be used in conjunction with the project specification document and Quality Assurance manual supplied by Allco Agencies Ltd. Please contact Allco Agencies Ltd with any questions and deviations from this information. All drawings are subject to copyright. Unauthorised use is prohibited. © Allco Agencies 2007



For Technical Advice Contact:

**Peter Stevens**  
**(0275) 420 225 (PS)**

**Alex Valentine**  
**(0275) 420 228 (AV)**