

SOLAR PANEL FIXING DETAILS

CT-3-0005
No Scale - 11/09

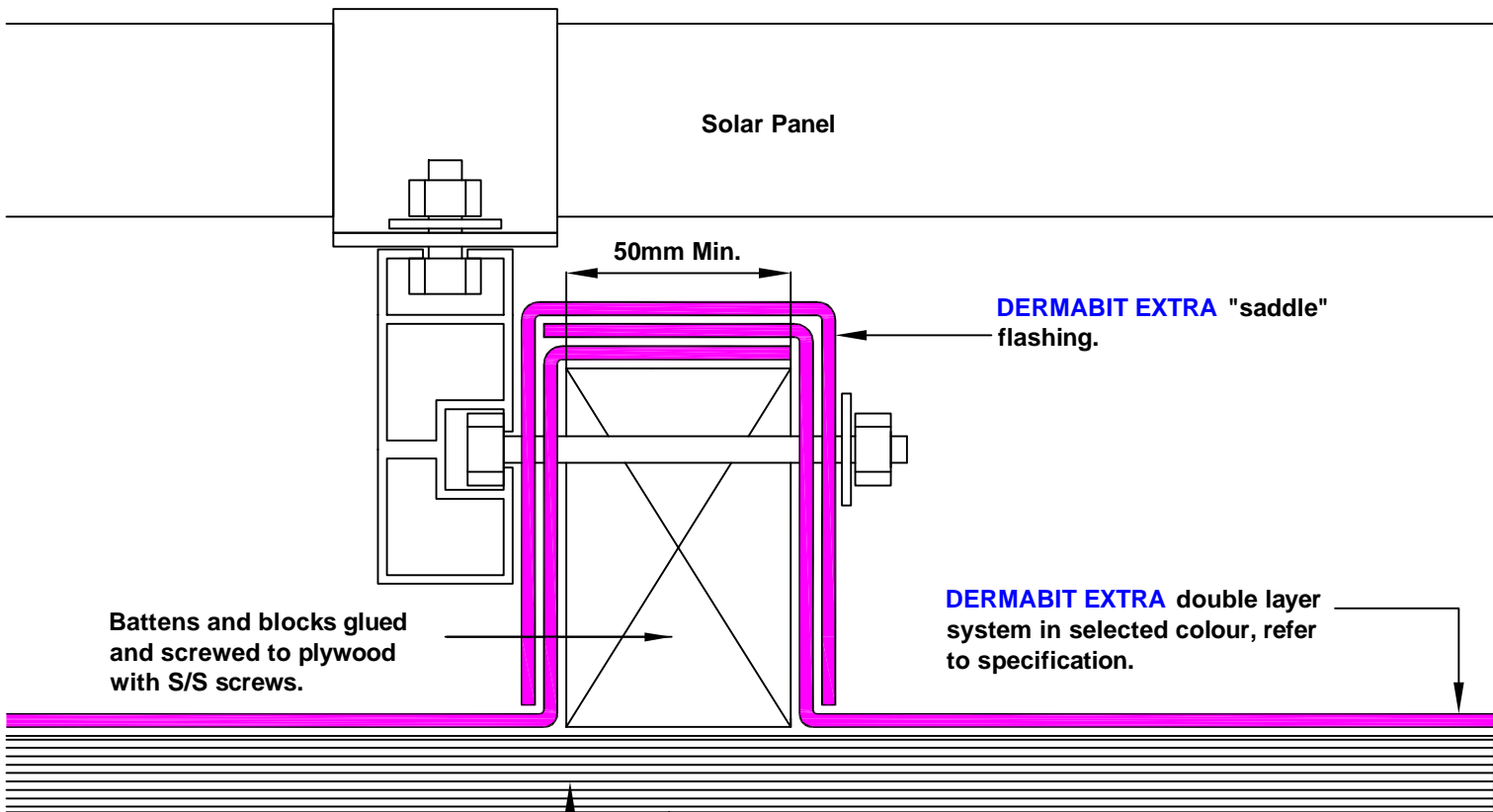

Battens and blocks glued and screwed to plywood with S/S screws.

DERMABIT EXTRA "saddle" flashing.

DERMABIT EXTRA double layer system in selected colour, refer to specification.

H3.2 "C" face plywood to 1:40 falls min. glued & screwed to timber rafters, all edges supported on timber at 400mm centers, including noggings and dwains, see specification.



The information and data contained herein are believed to be accurate and reliable. This information does not constitute a warranty and should be used in conjunction with the project specification document and Quality Assurance manual supplied by Allco Agencies Ltd. Please contact Allco Agencies Ltd with any questions or deviations from this information. Allco Agencies Ltd 2006
 "Reproduced from the Code of Practice for Torch-on Membrane Systems, the Membrane Group New Zealand, Inc"



For Technical Advice Contact:
 (09) 448-1185 or
 info@allco.co.nz